

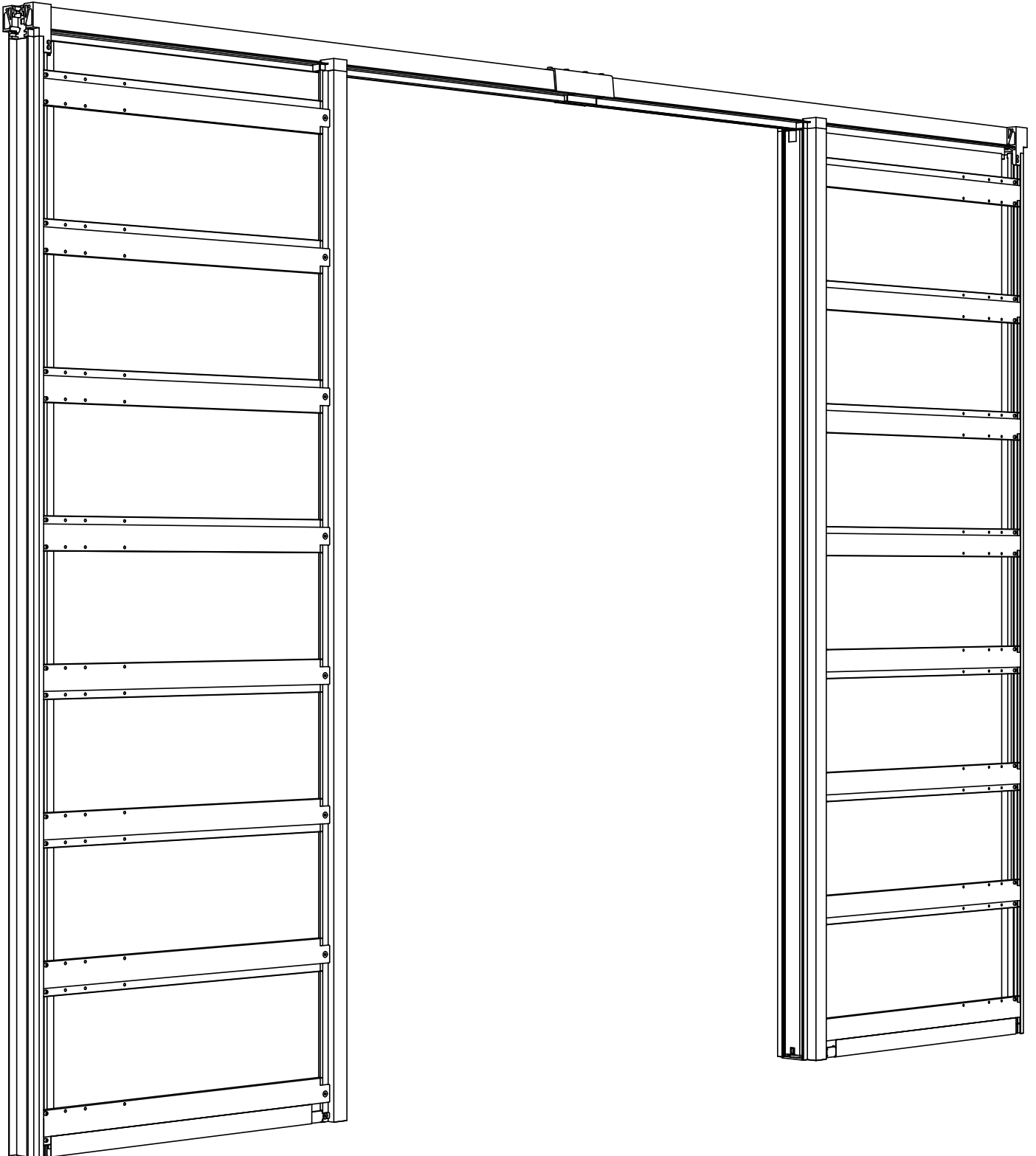

# LATENT POCKET

2X 80 KG - 2X 120 KG



# TOOLS

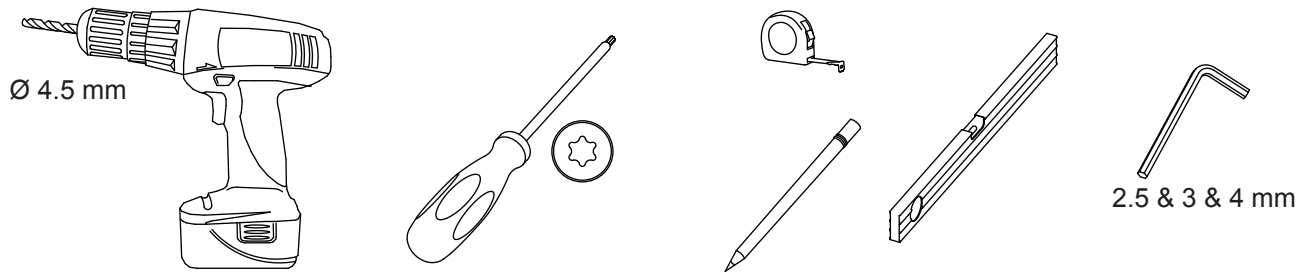

Necessary tools to finish the wall and ceiling.

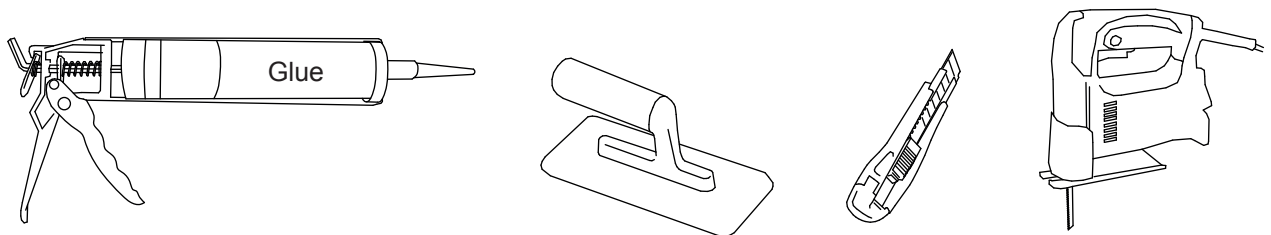

If your door is smaller than the pocket, then you will need a miter saw.

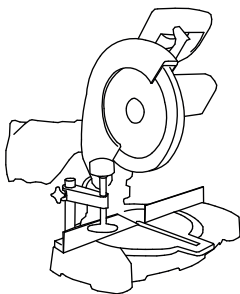

We recommend that the installation is carried out by two persons. Please also ensure that you have a small pair of steps or access platform.

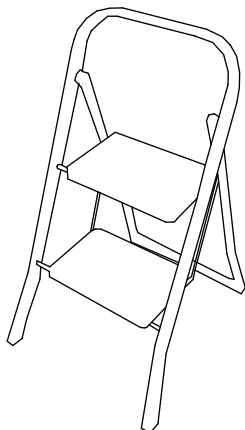

# COMPONENTS

- |   |                                  |   |                      |   |                      |
|---|----------------------------------|---|----------------------|---|----------------------|
| A | Running track profile            | H | Lead jamb connection | P | Ring M6              |
| B | Rear profile                     | I | Floor bracket        | Q | Bolt M6x12           |
| C | Lead jamb profile                | J | Screw 4x60           | R | Baseboard cross rail |
| D | Lead jamb bracket                | K | Bolt M6x10           | S | Brush seal           |
| E | Cross rail                       | L | Bolt M4x12           | T | Suspension profile   |
| F | Corner connection 80 kg version  | M | Acces pocket housing | U | Lower guide profile  |
| G | Corner connection 120 kg version | N | Clamping bracket     | V | Rubber end cap       |
|   |                                  | O | Clamping plate       |   |                      |

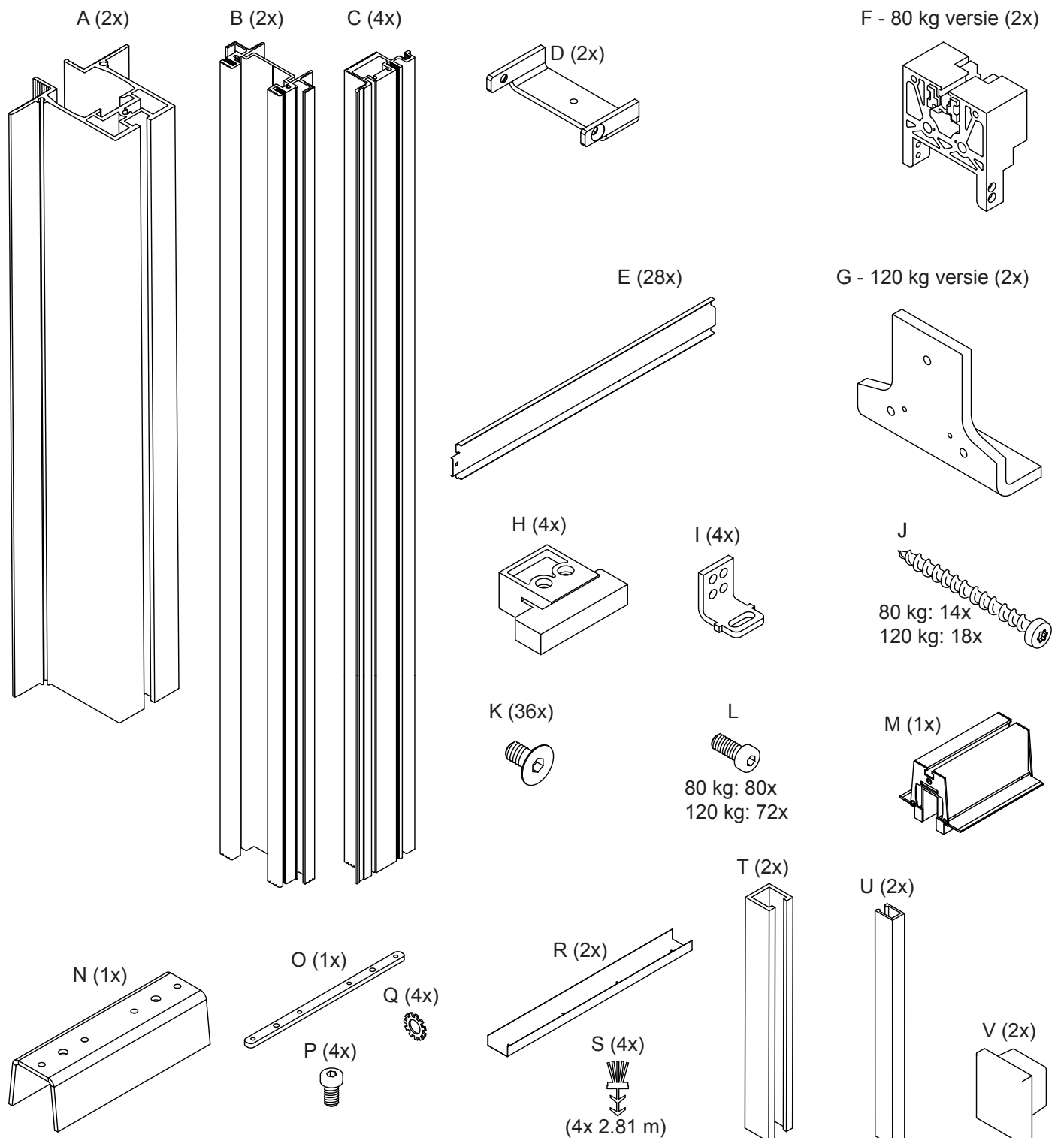

# VERTICAL CROSS SECTION

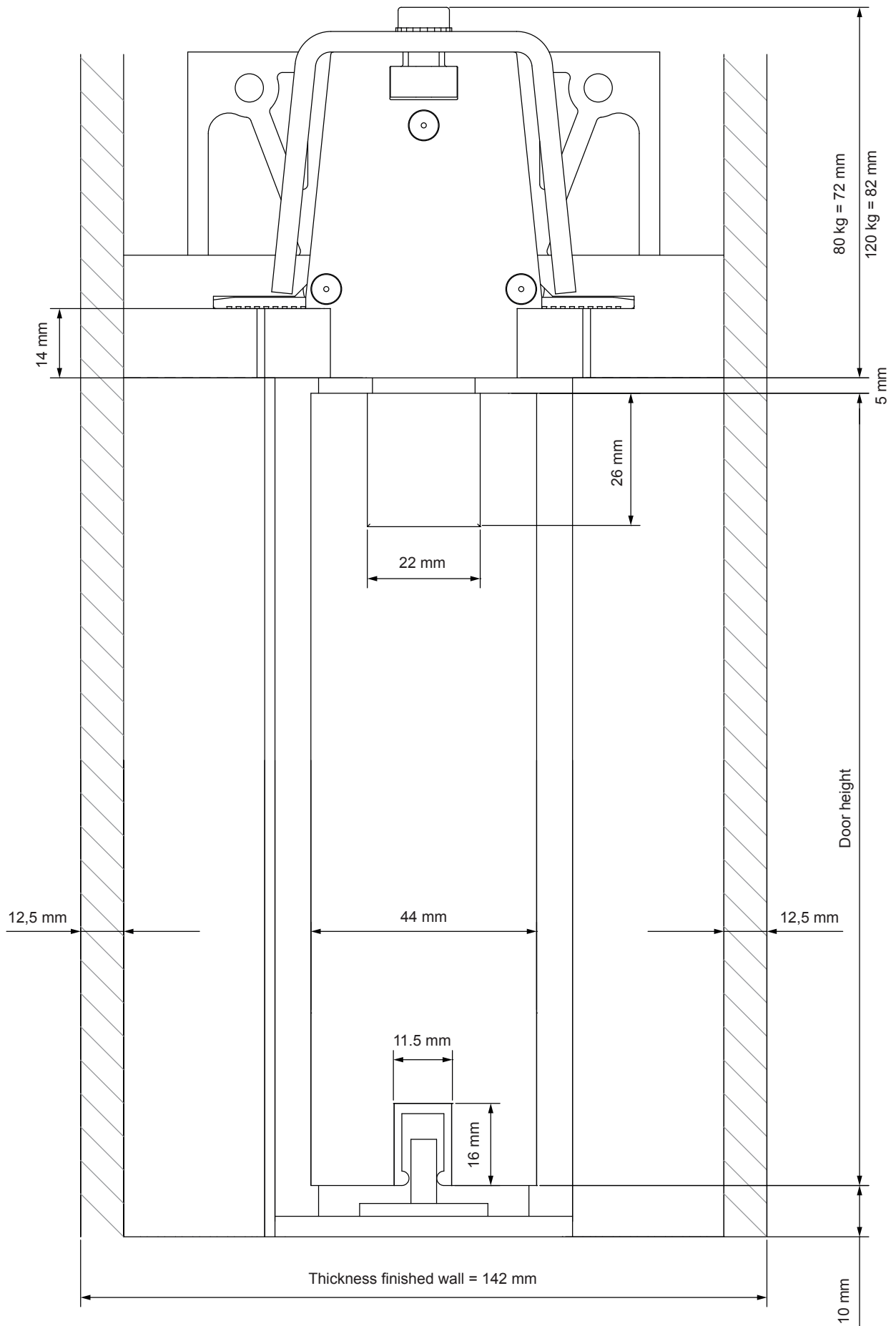

## CHECK UP + SAWING: IF NECESSARY

1. The cross rails are provided with small markers to indicate where to cut for a given standard door width. However if your door width is not standard, it is not a problem for the pocket area to be oversized in relation to the door width.

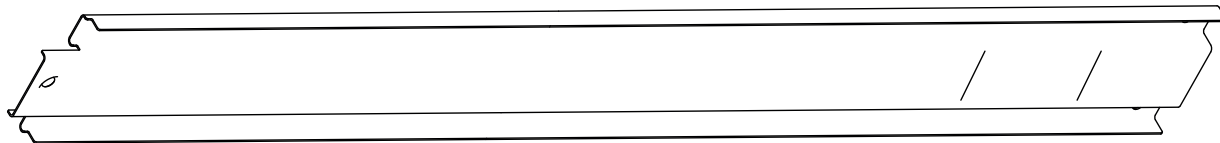

2. 80 kg version: length running track = length cross rail + door width - 90 mm  
120 kg version: length running track = length cross rail + door width - 123 mm

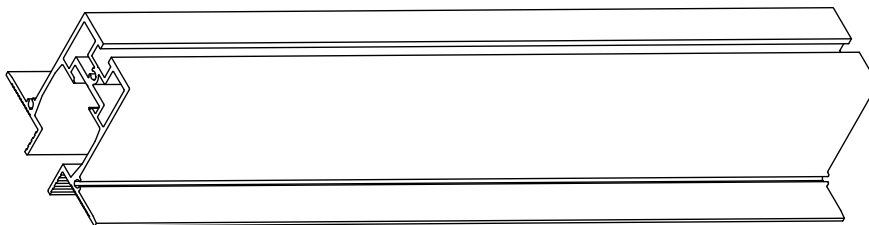

3. Length profile = door height + 15 mm

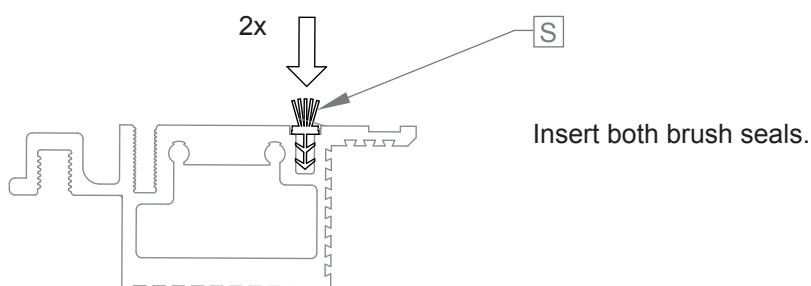
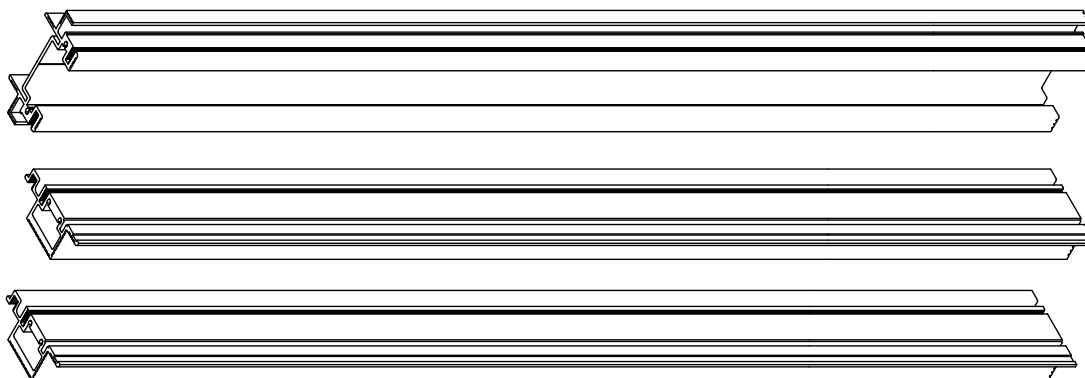

# 1

Insert the lead jamb connection (don't screw in place at this stage).

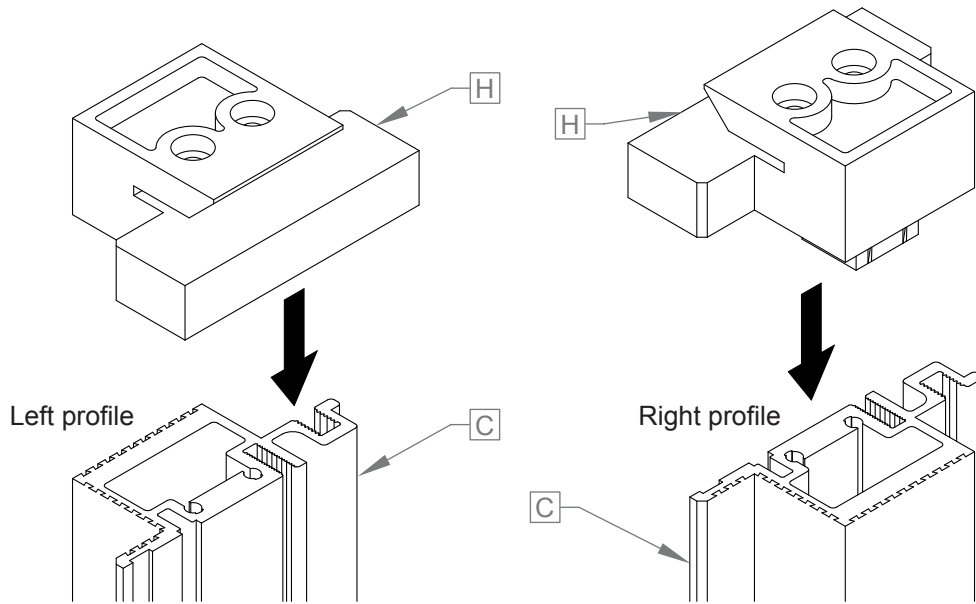

# 2

Mount the corner connection to the rear profile.

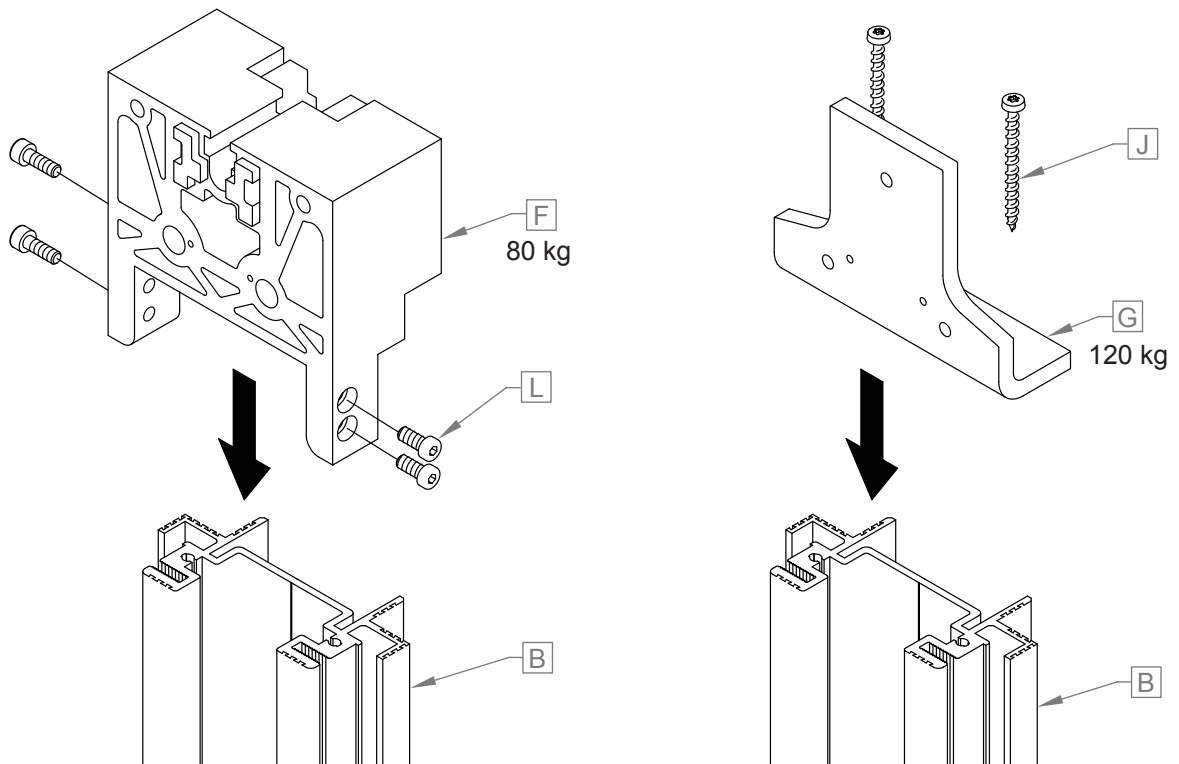

### 3

Connect the running track to the rear profile.

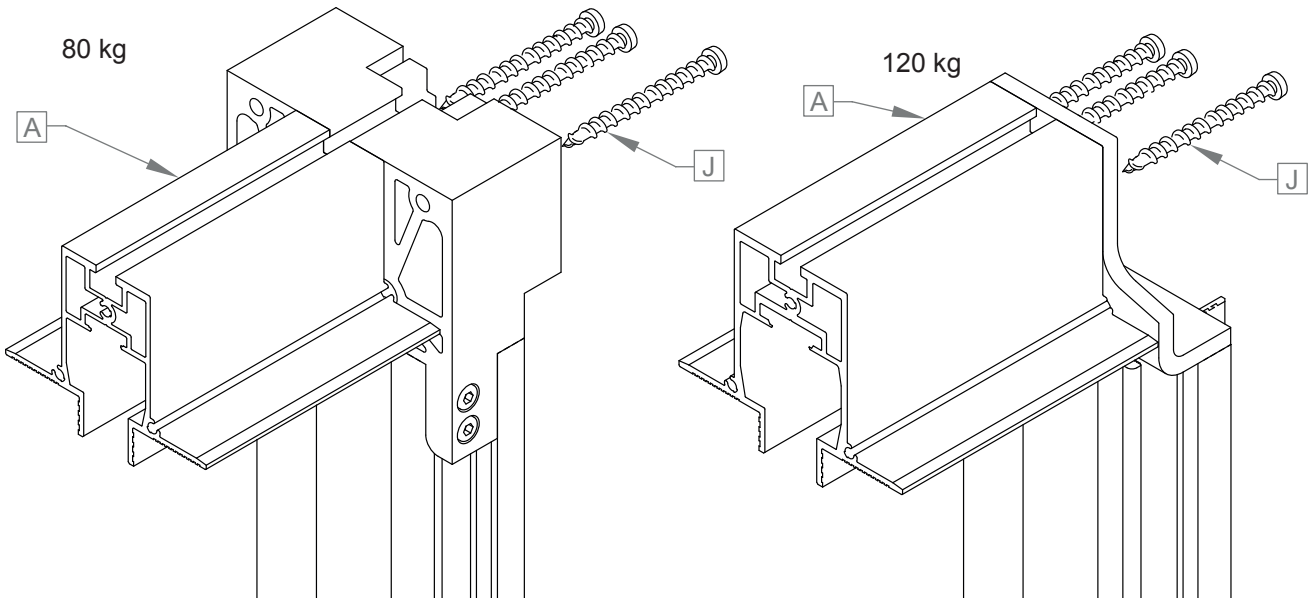

### 4

If you have chosen an 'auto-eject', connect the bracket now.

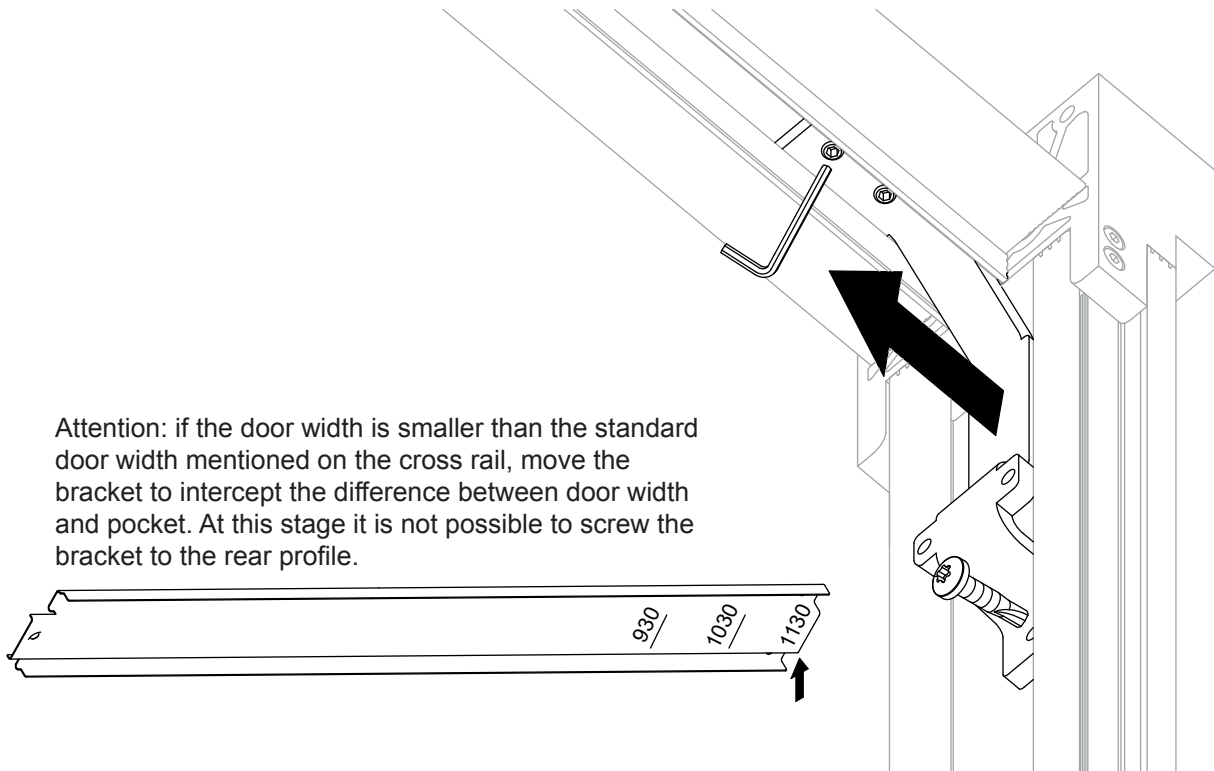

5

Slide the lead jambs on the running track (don't screw in place at this stage).

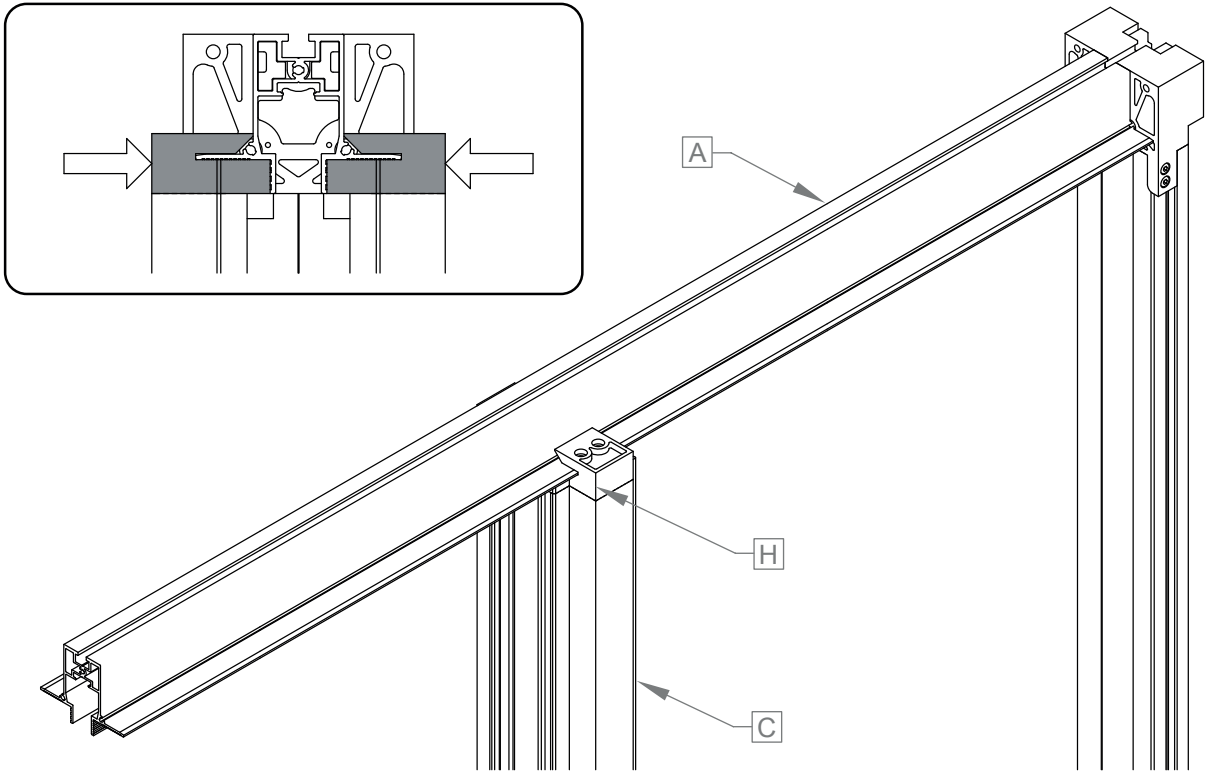

6

Mount the lead jamb bracket.

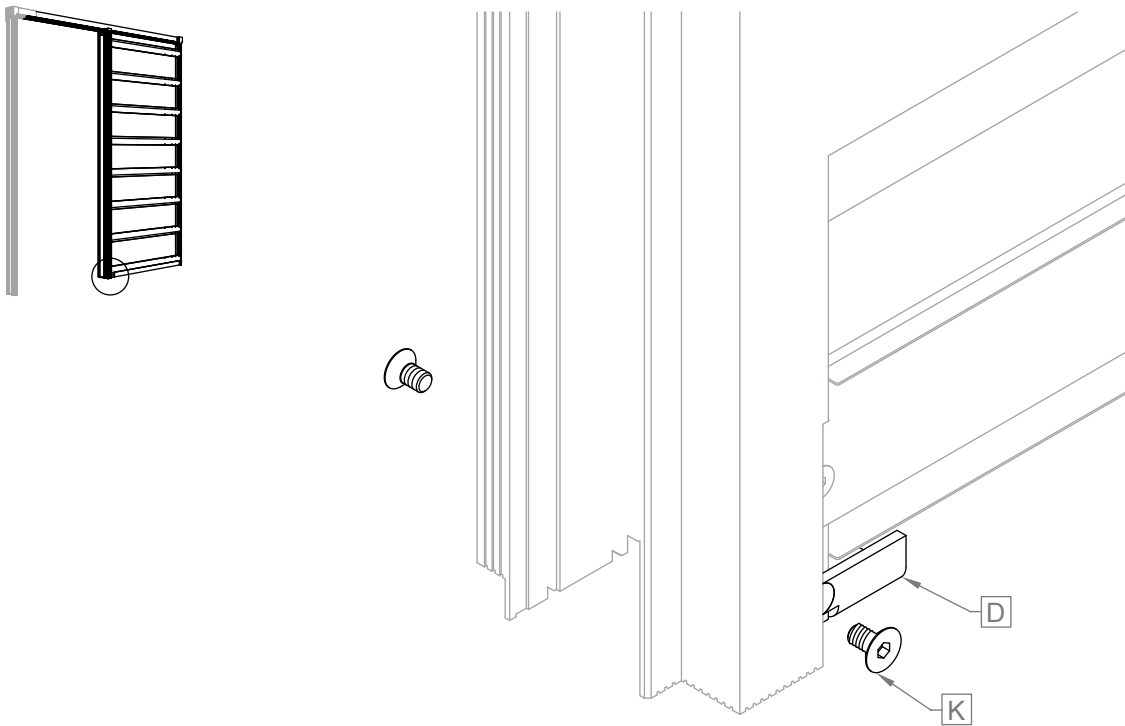

Mount the cross rails, this will now determine the fixing position for the lead jambs.

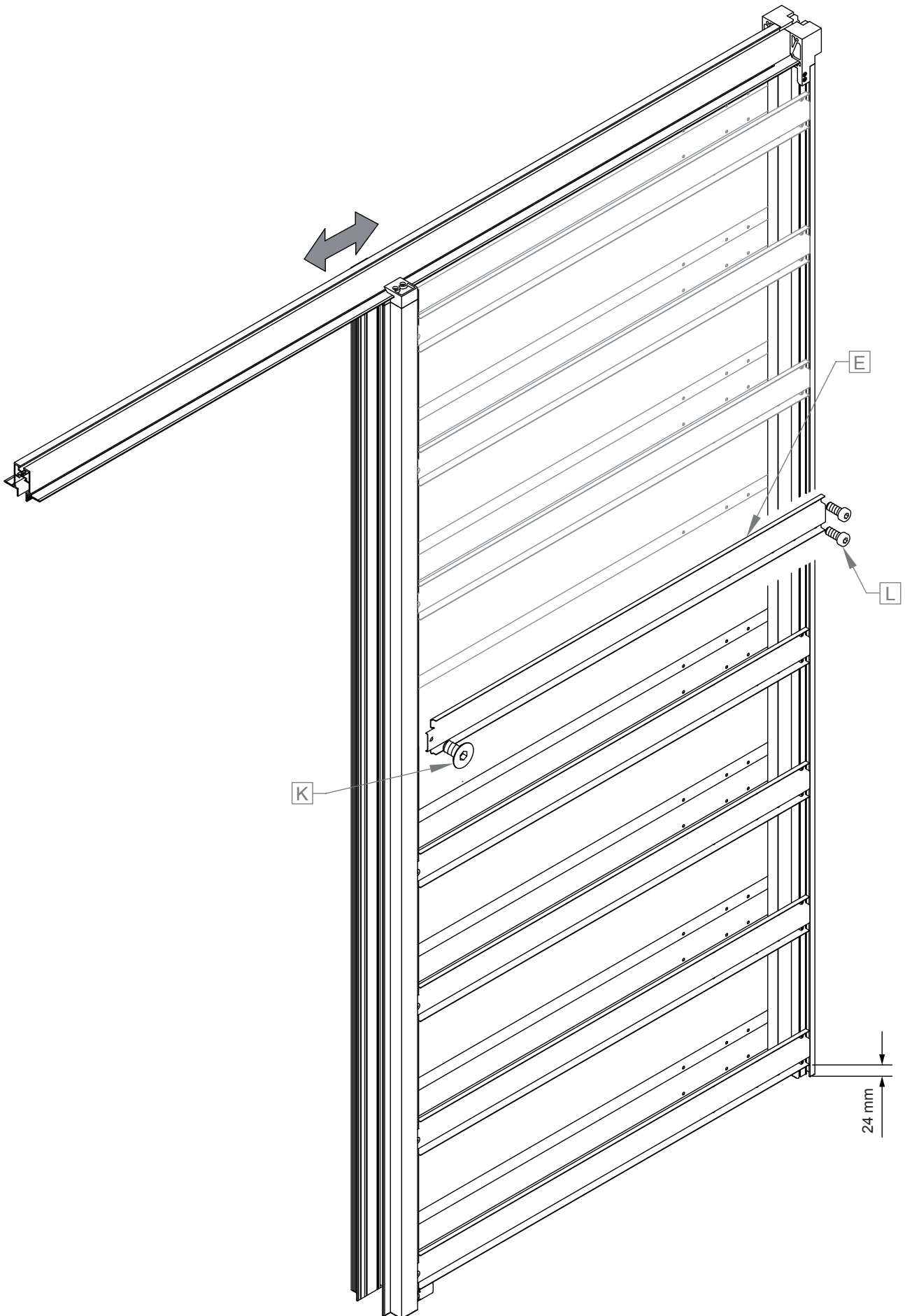

8

Ensure that the lead jamb connection and push fully into position, then drill two holes through the running track flange, fix in position taking care not to overtighten the screws.

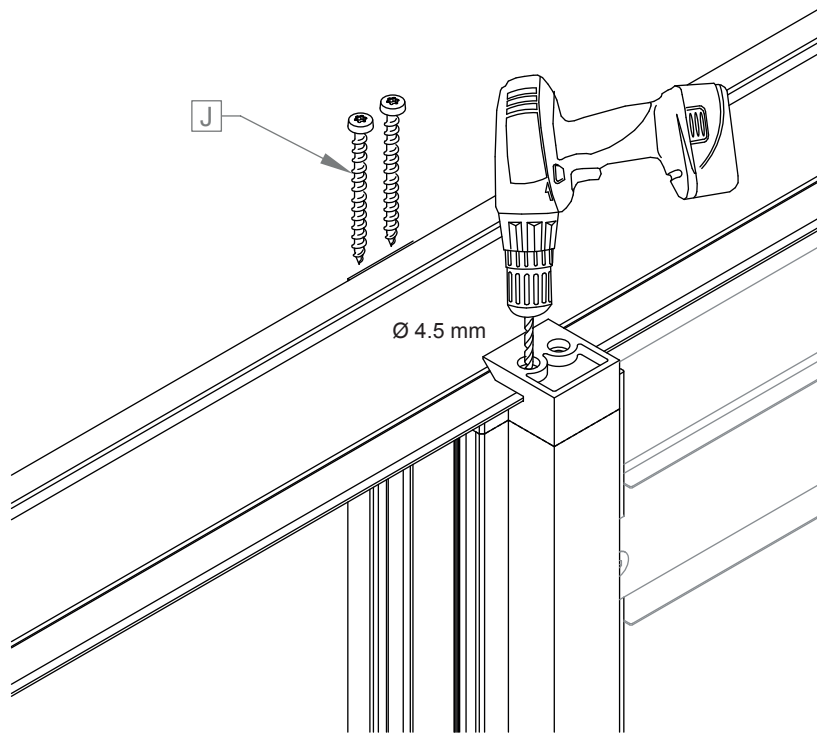

9

Mount the optional floor brackets.

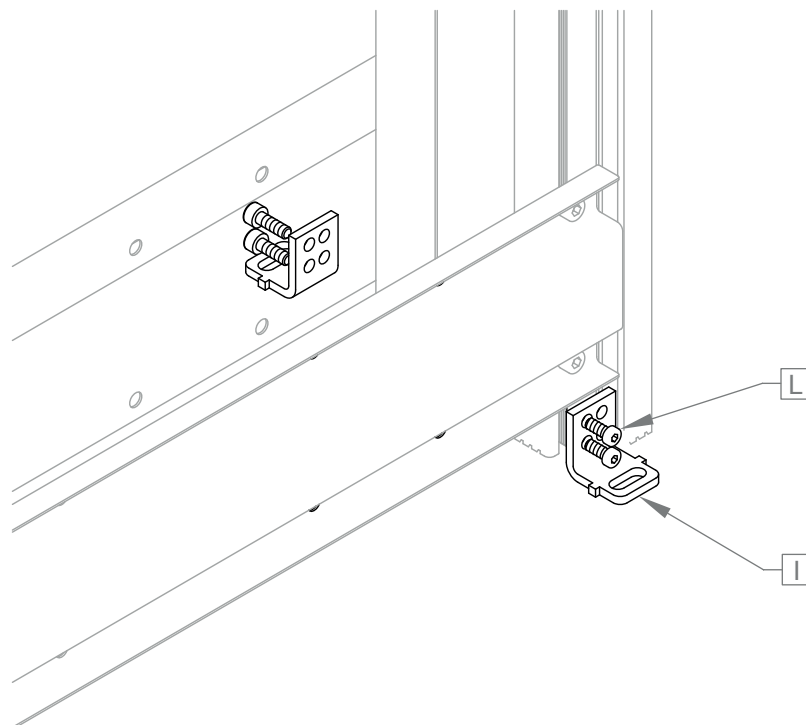

10

Repeat step 1 - 9 for the second frame.

11

Disassemble the acces pocket housing.

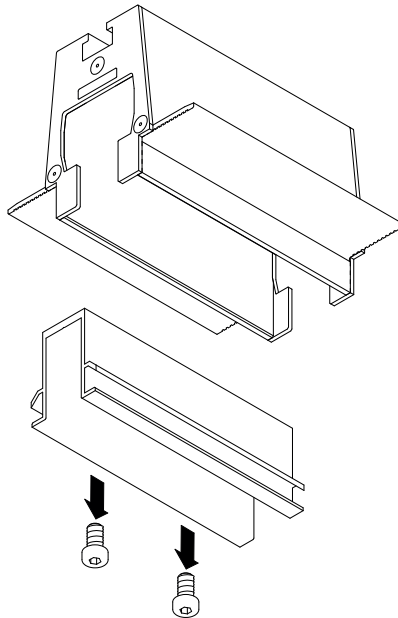

12

Mount the housing and the clamping plate to the running track.

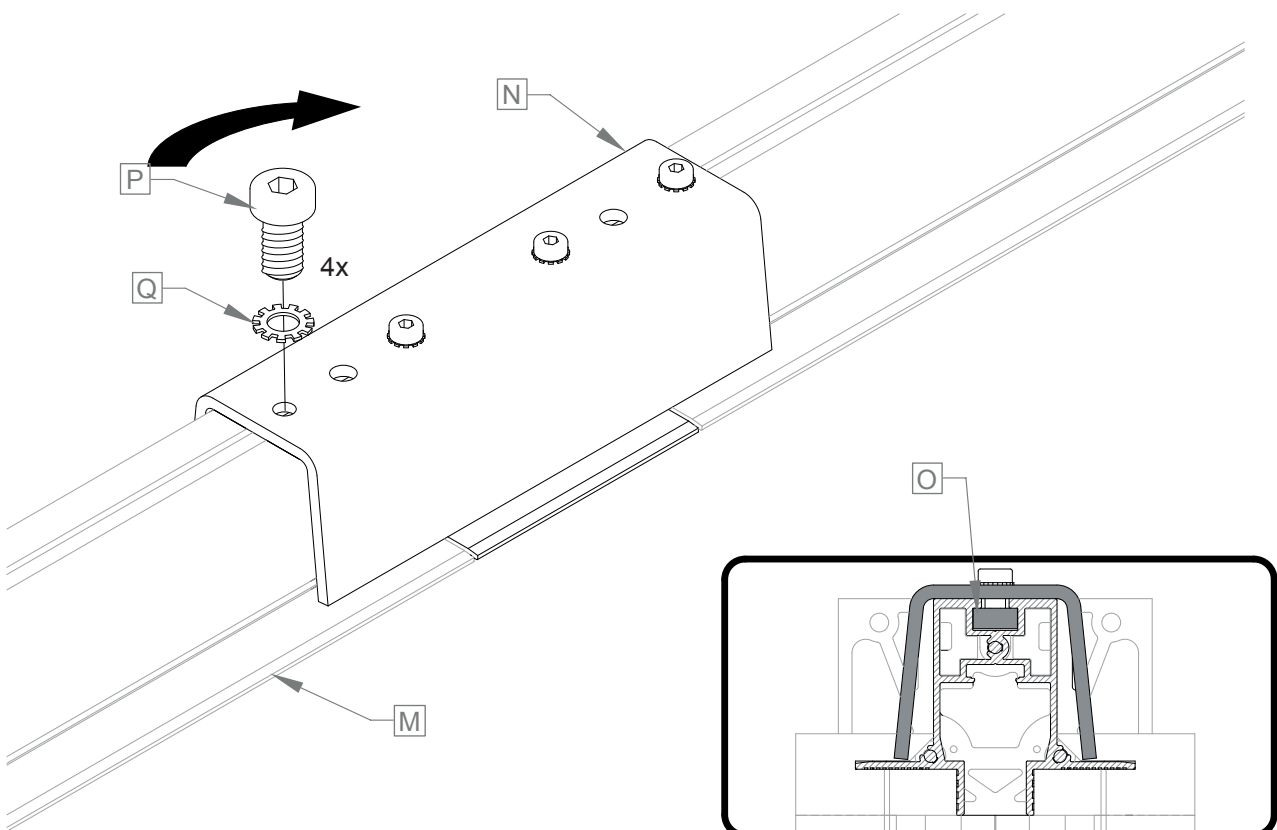

Lay the optional baseboard cross rail to the floor and put the pocket on it.

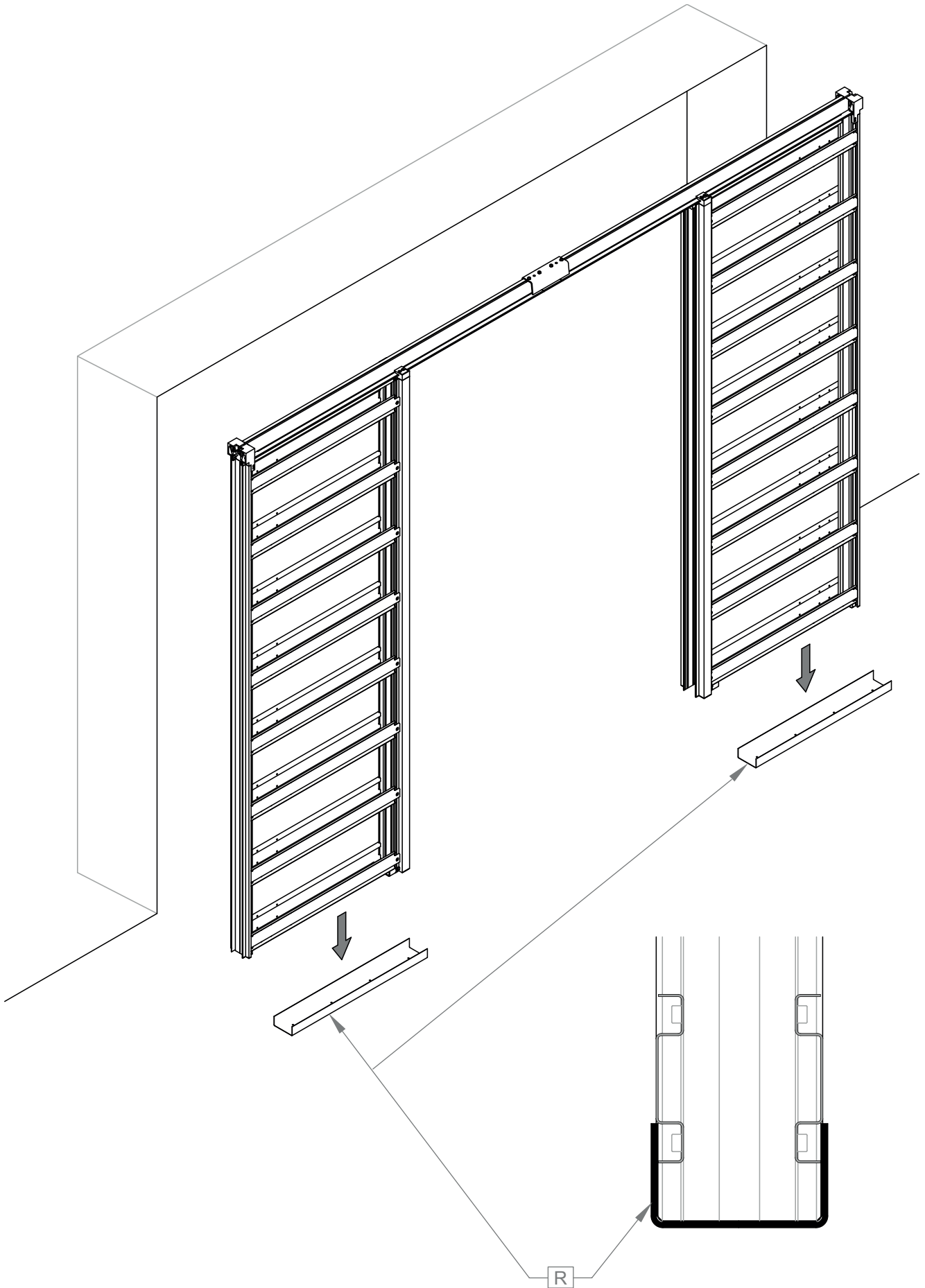

Fix the pocket against the wall, ceiling and floor.

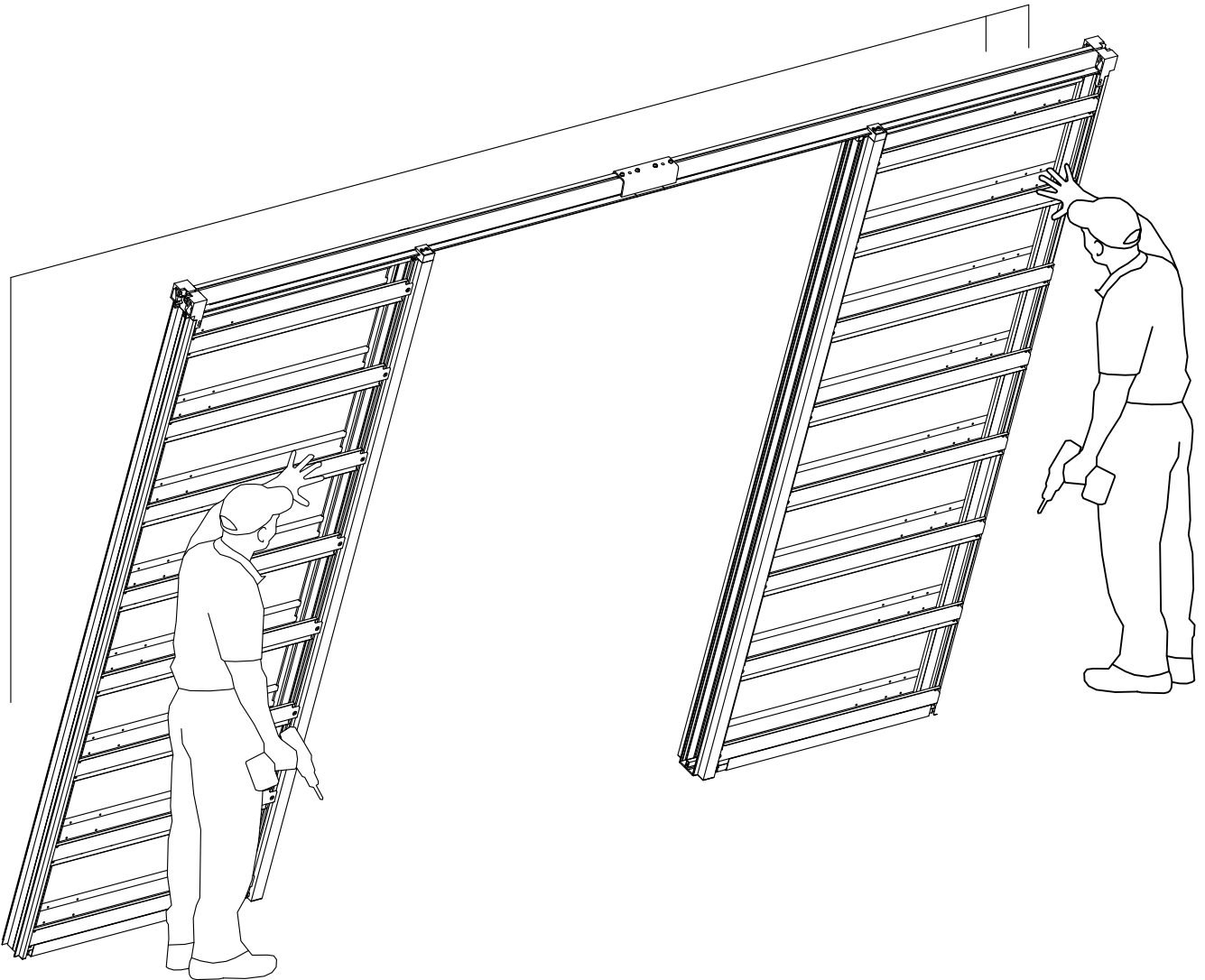

The door leaf now requires some routed grooves to accept the compact profile and lower guide profiles as follows. The suspension profile must be fixed into the door with woodscrews and the lower guide profile is glued.

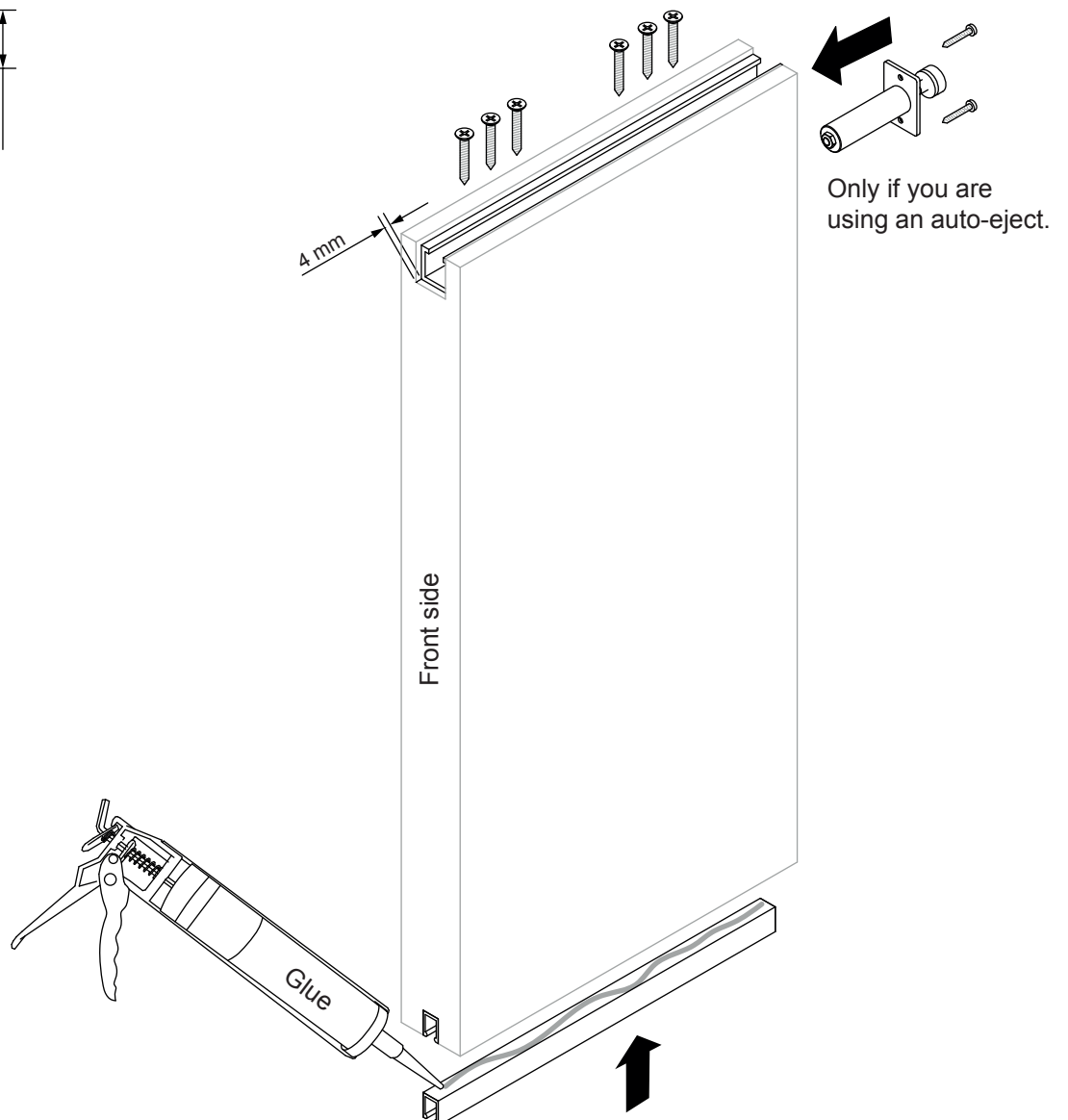
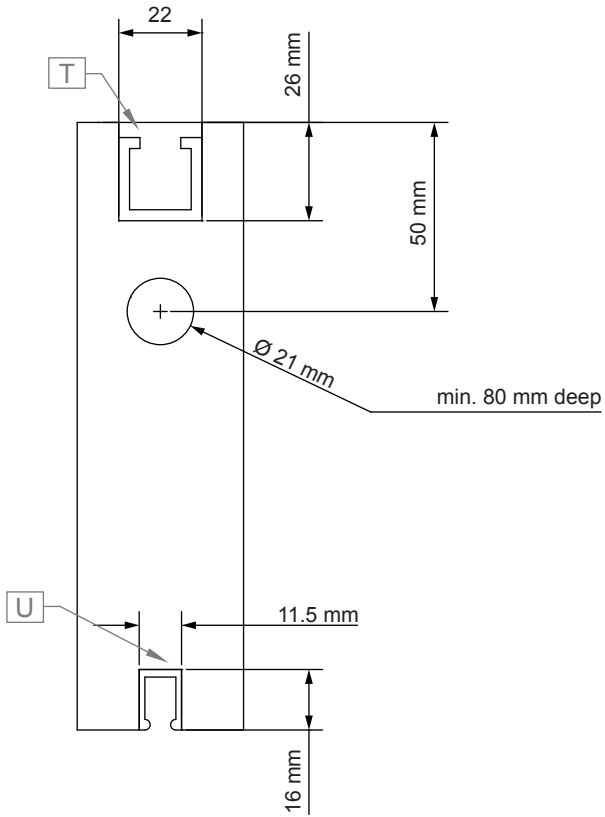

## 2 ROLLS

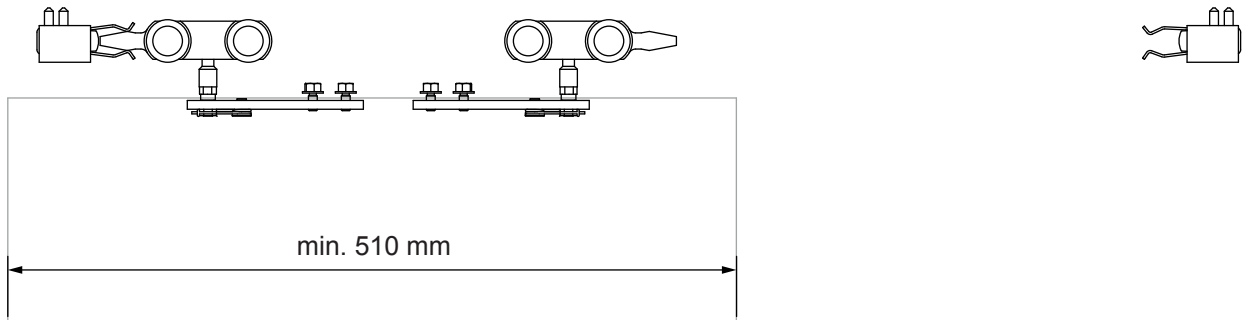

## COMPONENTS

- CA Roll
- CB Stopper
- CC Guide
- CD Wrench

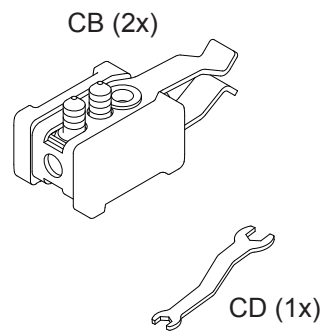
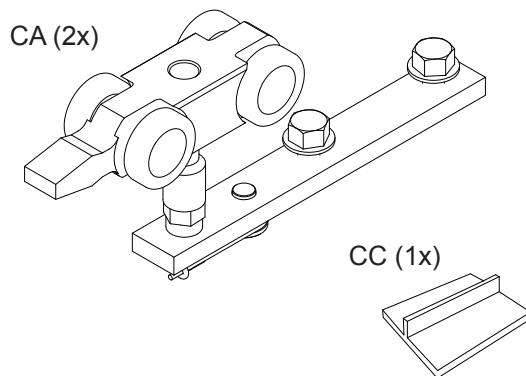

# 1 ROLL + SOFTCLOSE

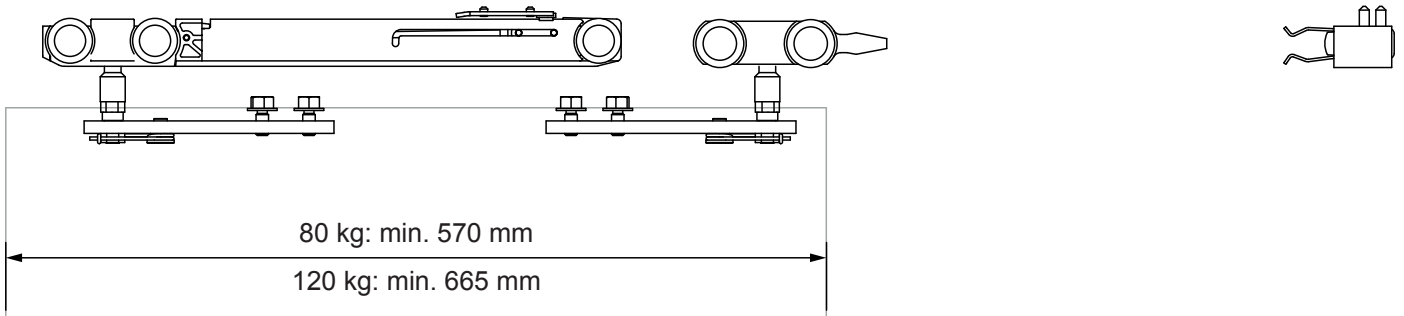

## COMPONENTS

- CA Roll
- CB Stopper
- CC Guide
- CD Wrench
- CE Softclose
- CF Actuator
- CG Bolt M5

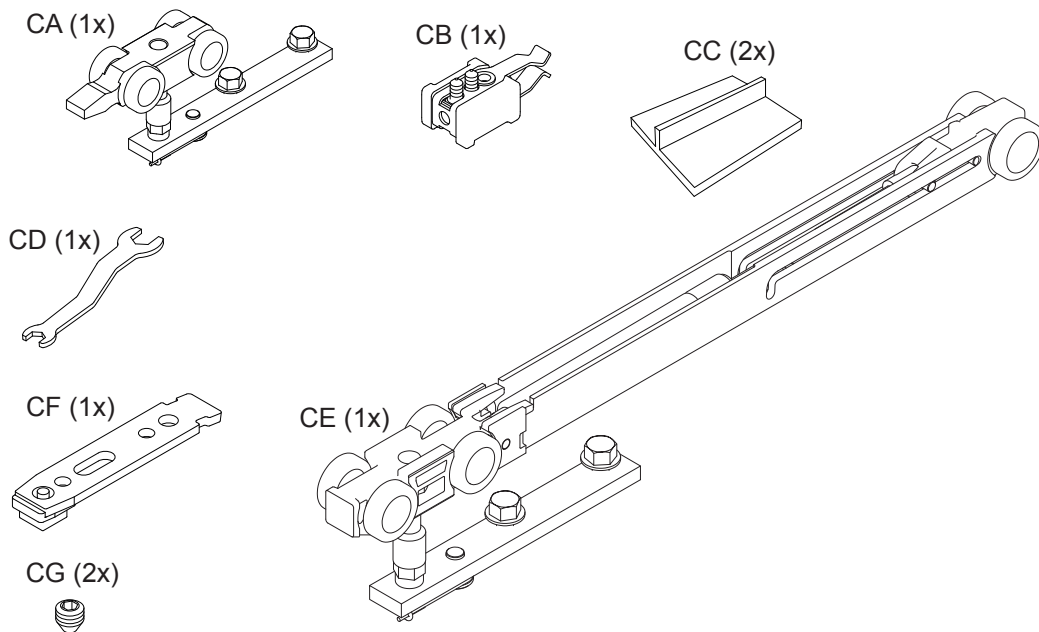

2 rolls

1 roll + 1 softclose

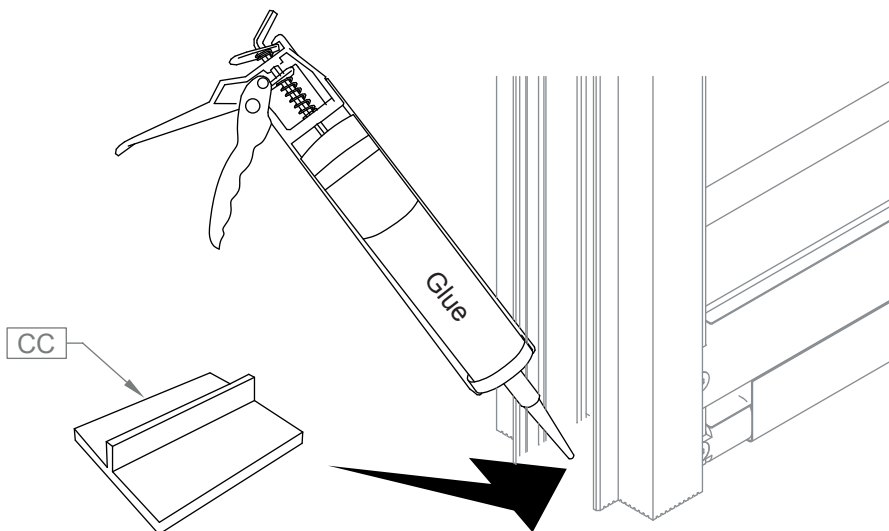
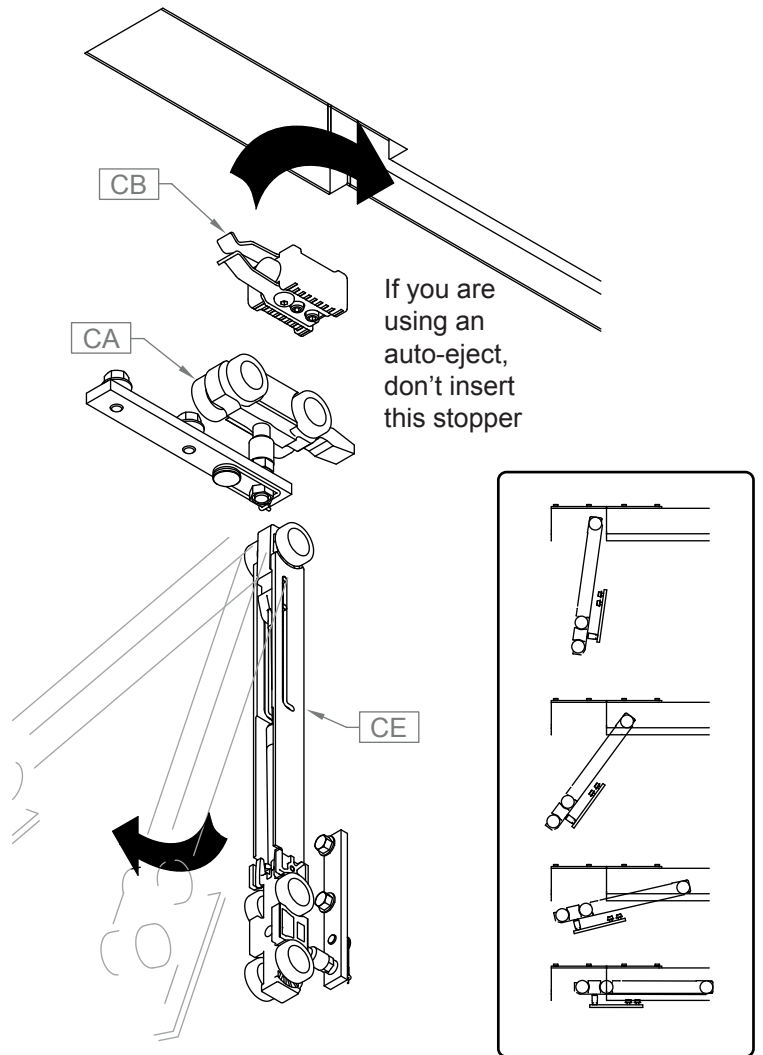
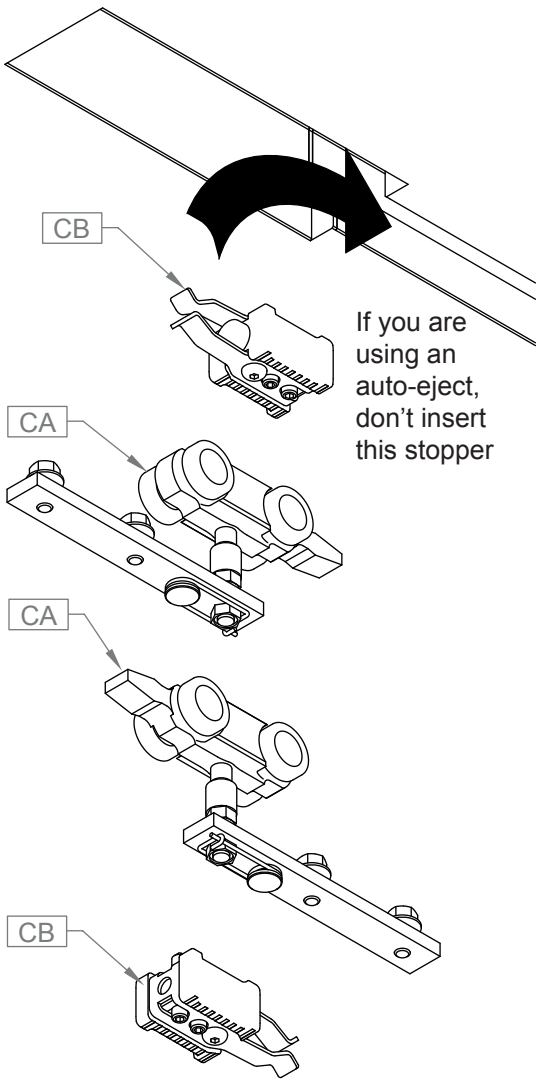

18

Fix the stopper in place (not when you are using a auto-eject).

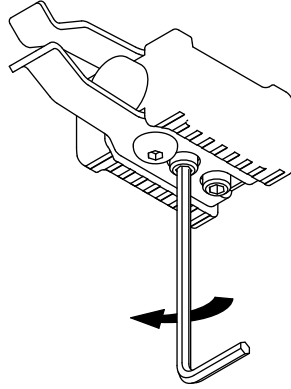

19

Slide the rear roller into the compact profile and tighten the 2 bolts.

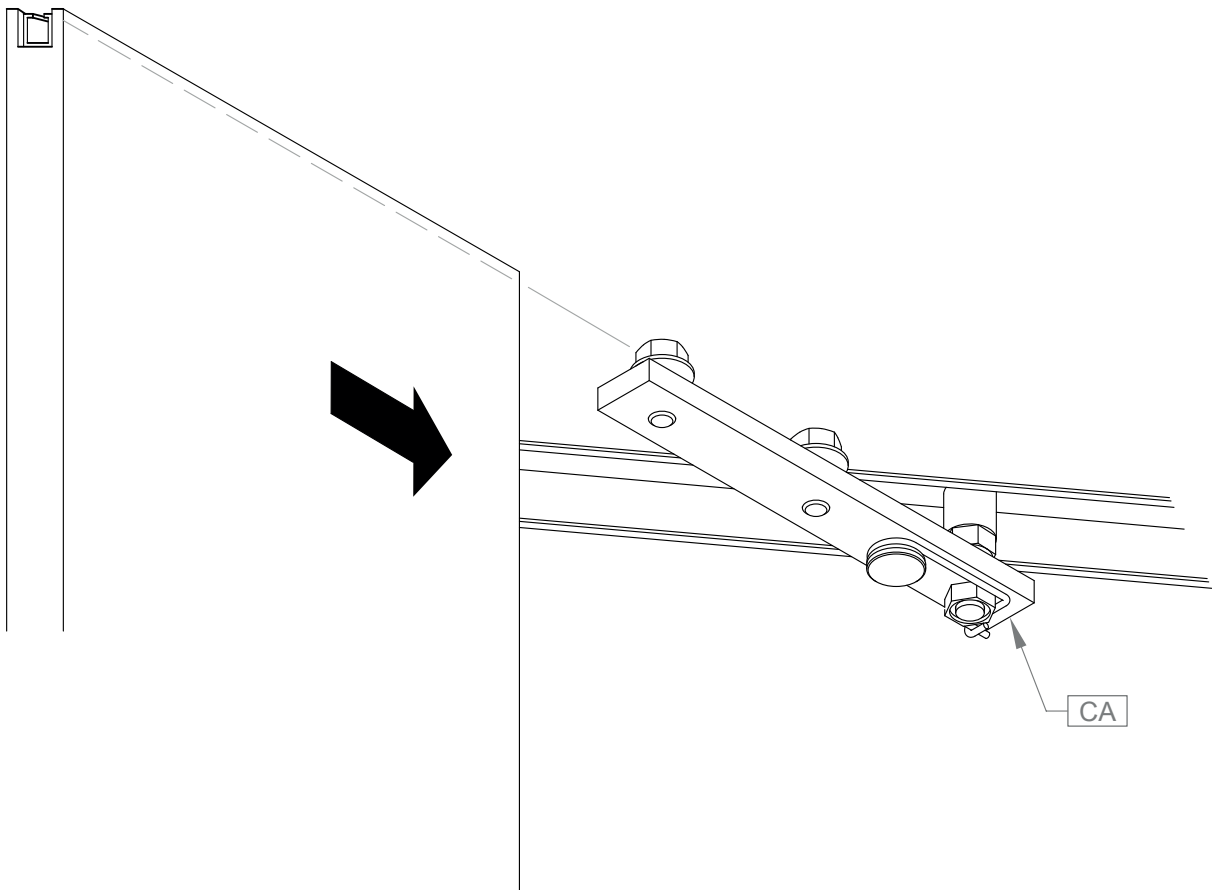

20

Move the door in the opening until it aligns with the sliding movement.

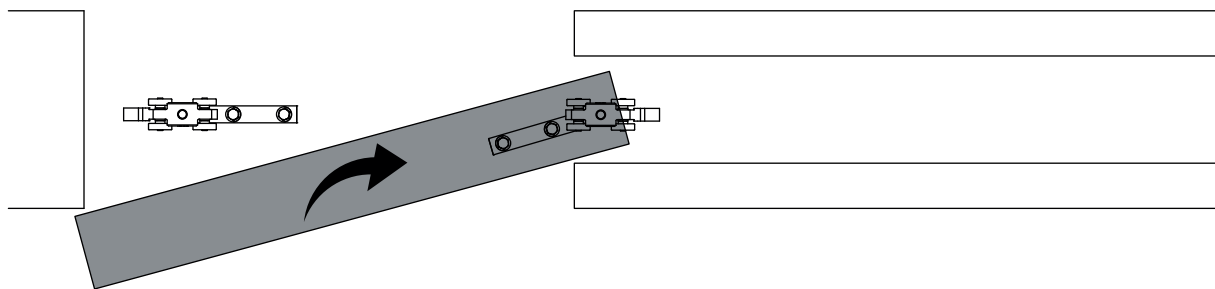

21

Move the door into the wall and slide the front roller into the compact profile.

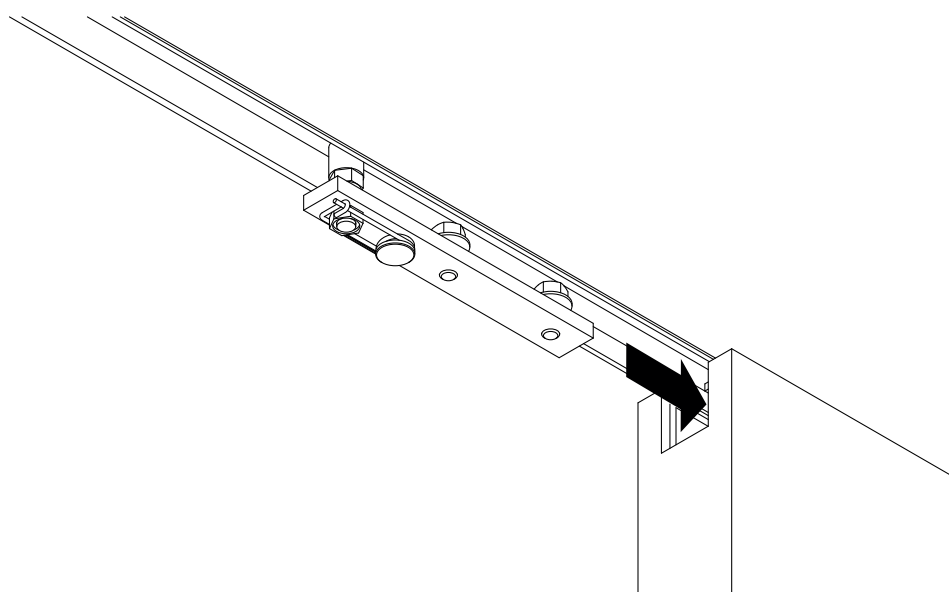

22

Position the rollers and secure them to the compact profile, as shown.

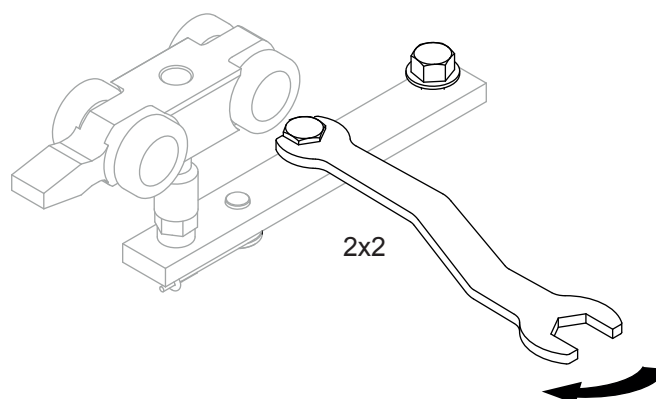

# 23

Adjust the door height.

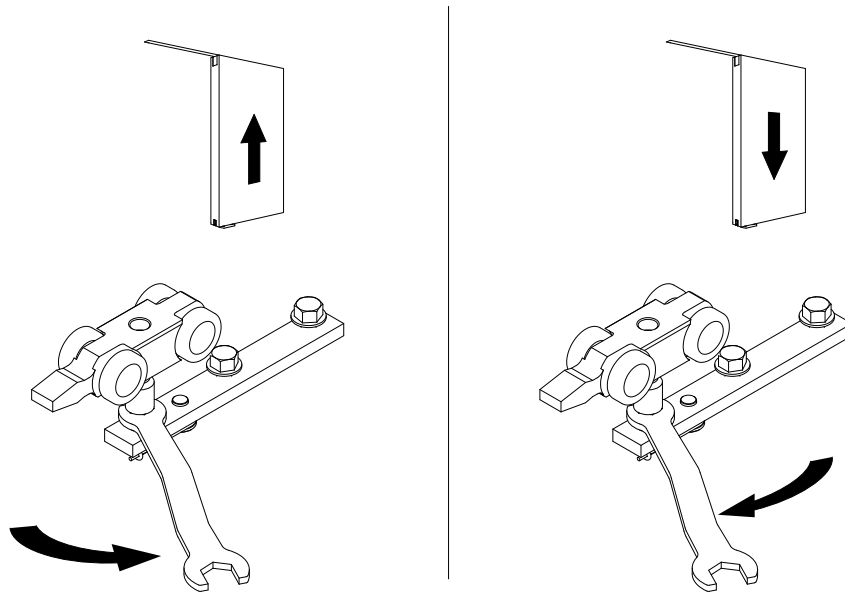

# 24

When using a stopper, it must be positioned correctly to achieve the required open position. This position can also be obtained by shifting the roller.

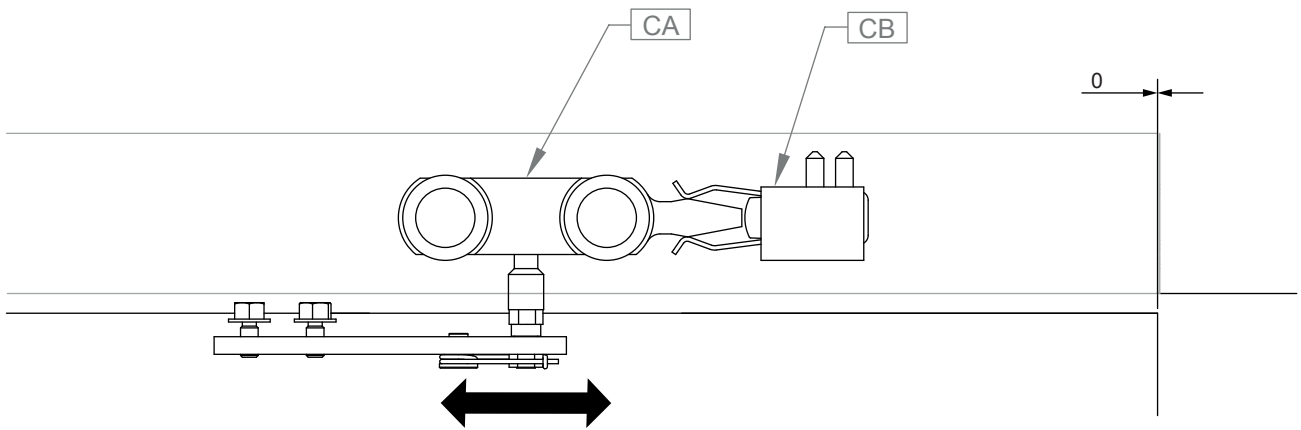

# 25 IN CASE OF 2 ROLLS

Position the first roller so that the door closes at the preferred position.

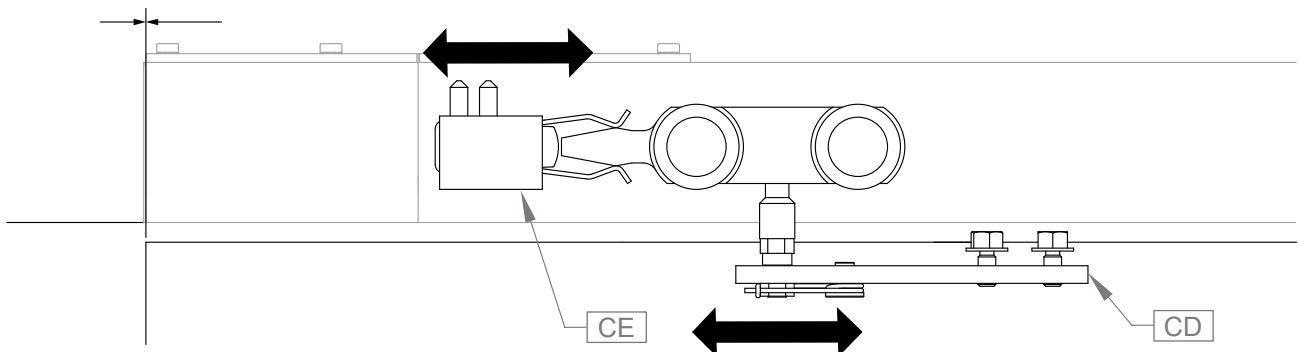

## 26 IN CASE OF ROLL + SOFTCLOSE

Insert the softclose actuator as shown, lightly tighten in the approx position and test the softclose, adjust accordingly and the tighten.

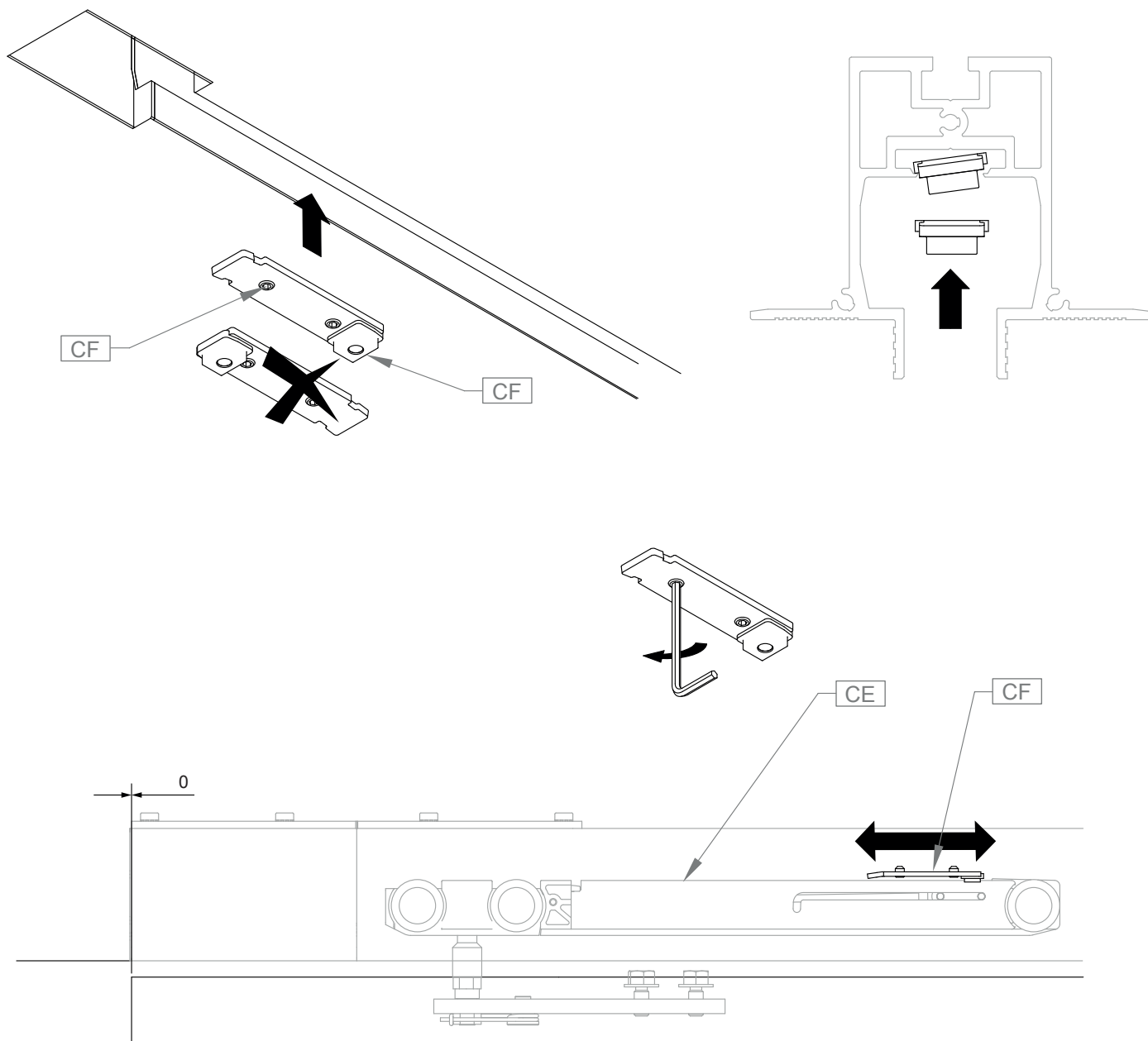

## 27

Insert the suspension end cap as shown.

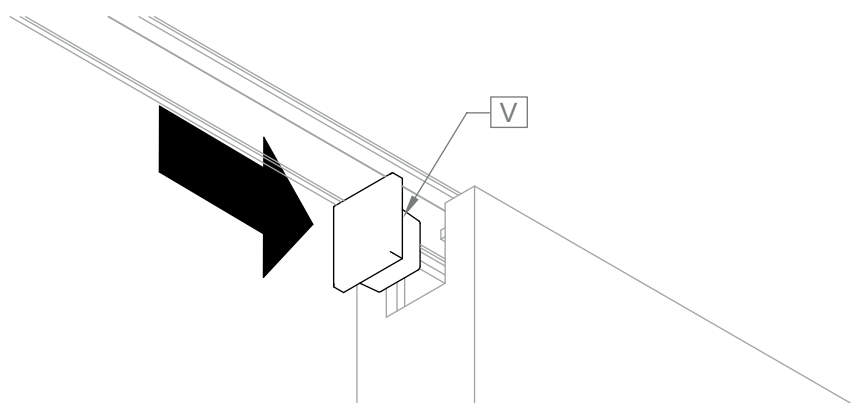

Re-insert the acces pocket inner part and secure with the bolts.

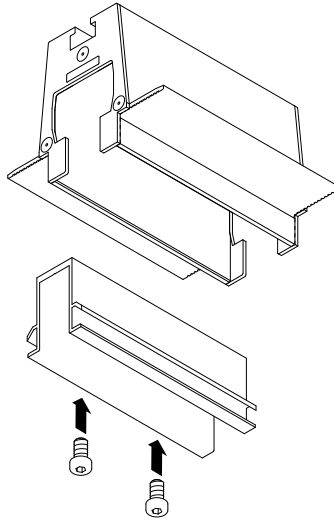

The pocket can now be boarded, with plasterboard of 12,5mm or other materials. We recommend that the first layer of board is bonded to the pocket to avoid the possibility of screws being used that are too long, this could lead to damage on the door as it slides into the pocket.

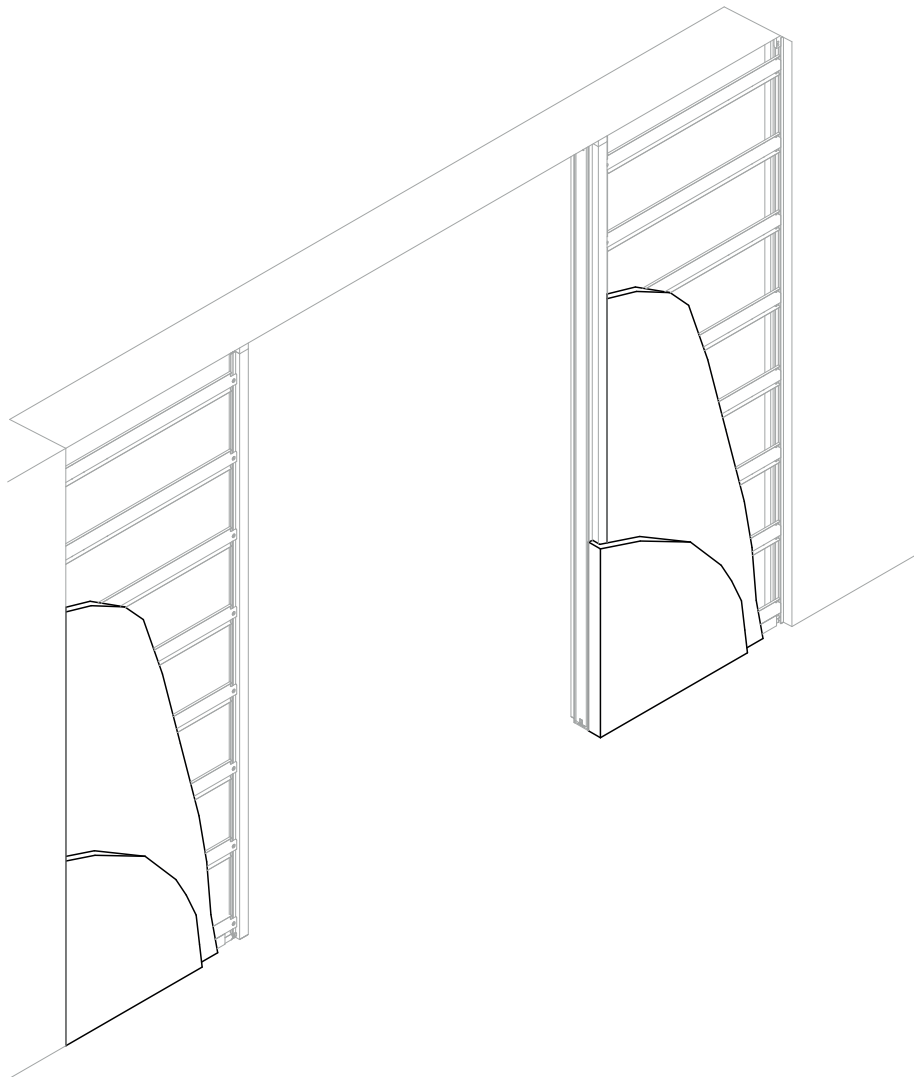





## LOUAGE & WISSELINCK

HEADQUARTERS  
STATIONSTRAAT 221  
8850 ARDOOIE  
BELGIUM

COMMERCIAL SERVICE  
TER VLUCHT 2  
8850 ARDOOIE  
BELGIUM

WWW.ROB.BE  
INFO@ROB.BE  
TEL. +32 (0)51 74 48 01  
FAX. +32 (0)51 74 48 05